

# Montageanleitung Komplett Dusche "Astoria"

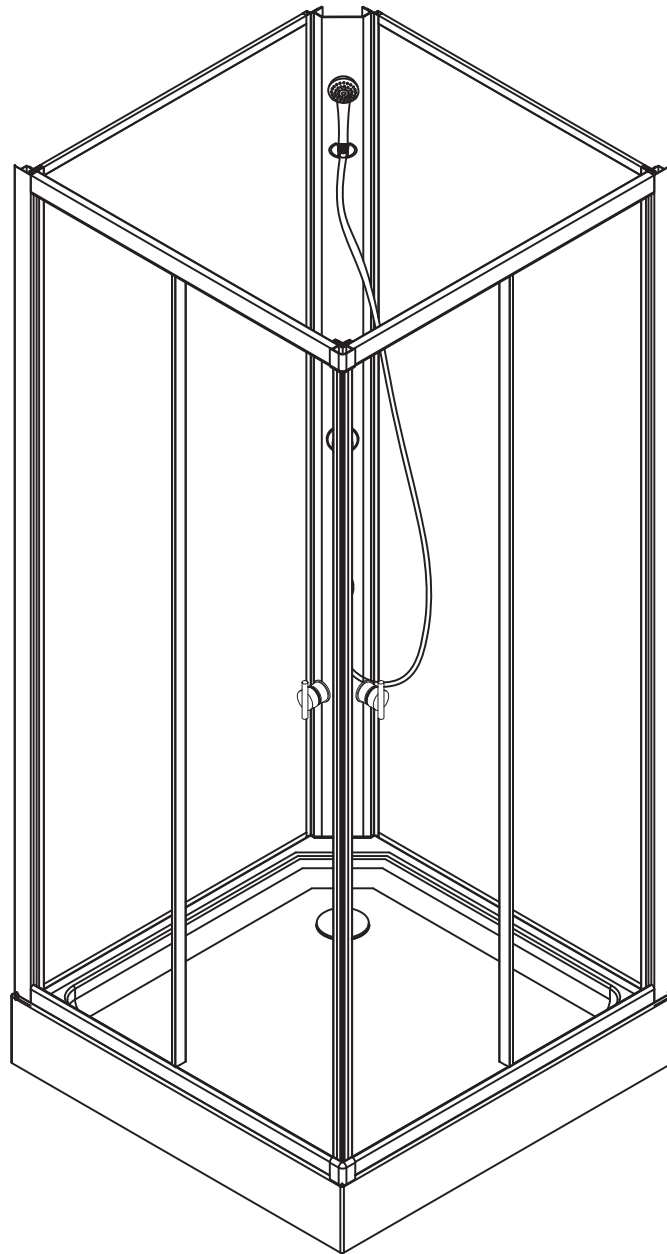

800 x 800 x 1950 mm  
Artikelnummer: DM2013 1152013A

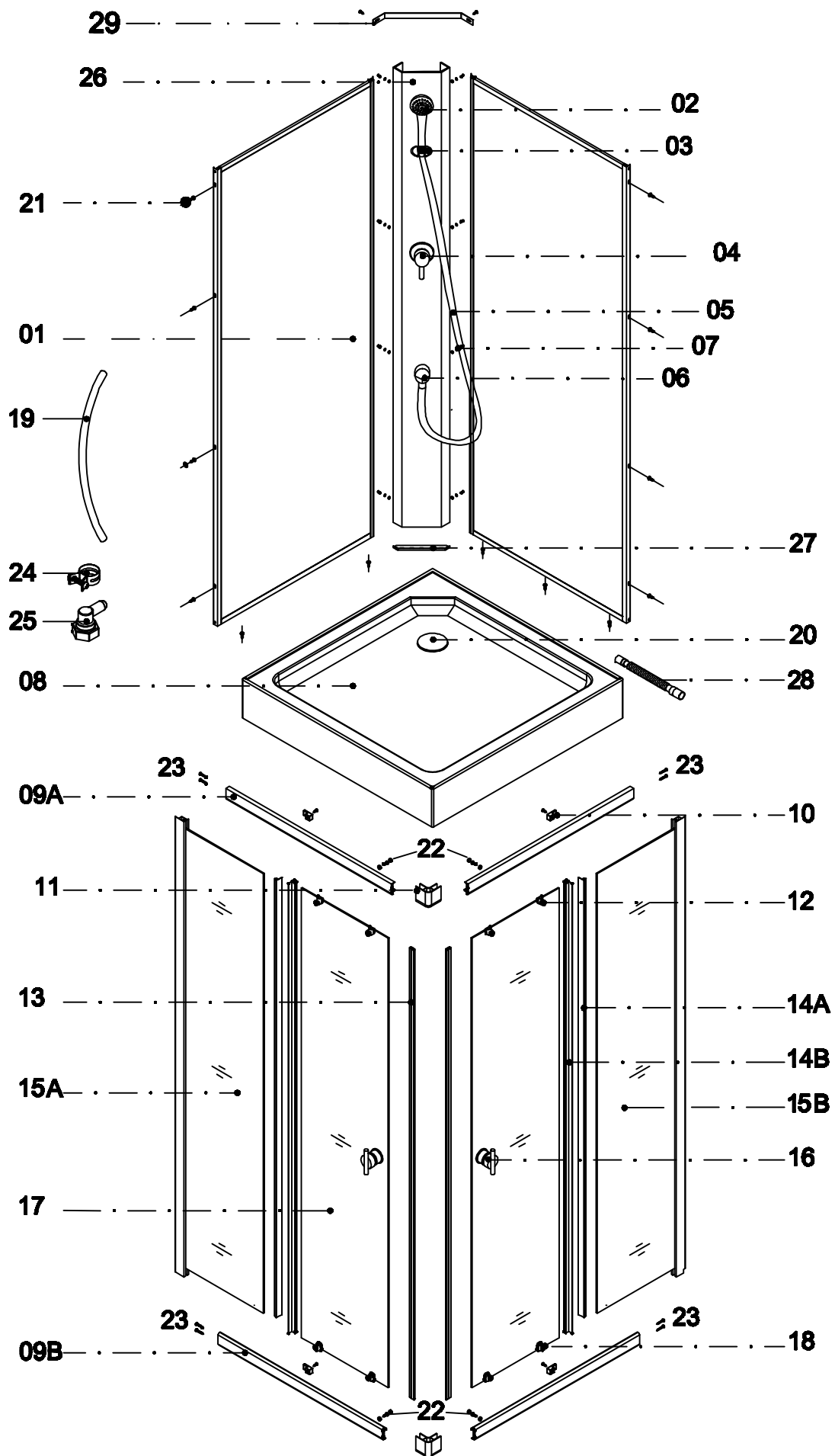



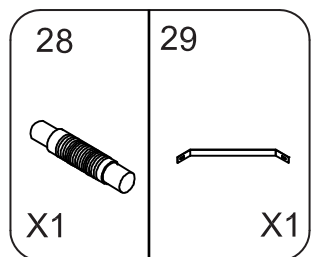
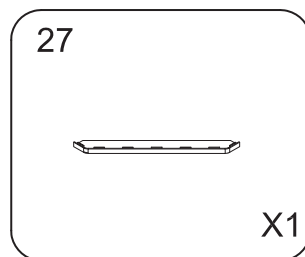
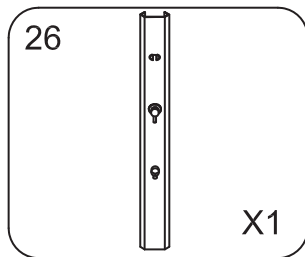
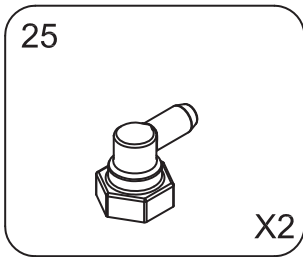
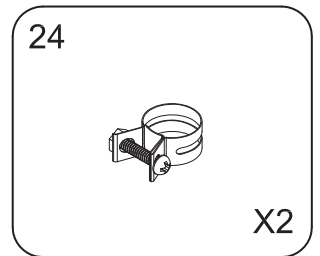
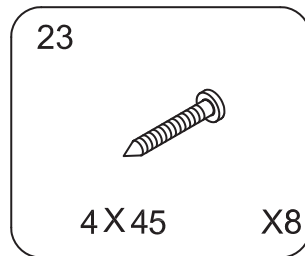
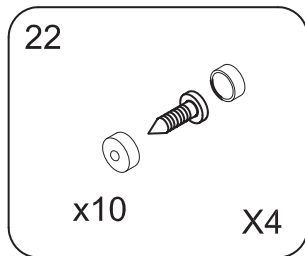
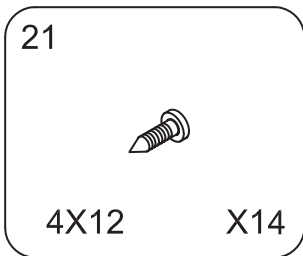
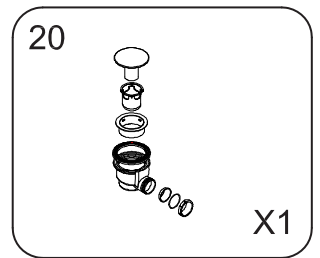
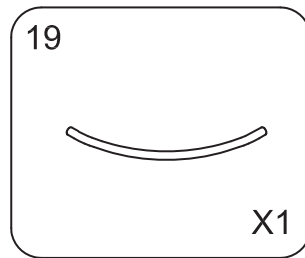
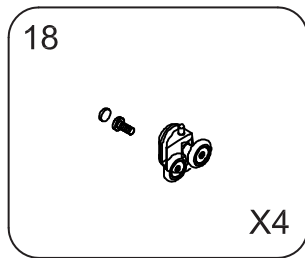
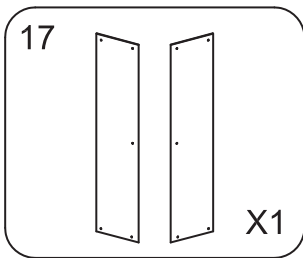
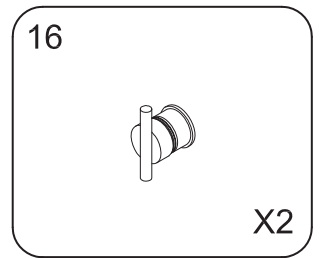
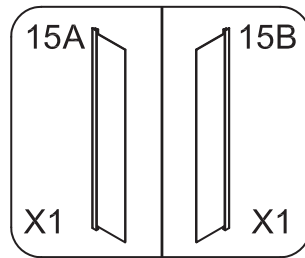
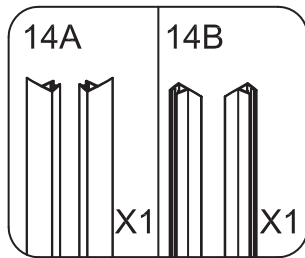
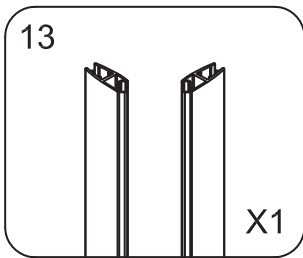
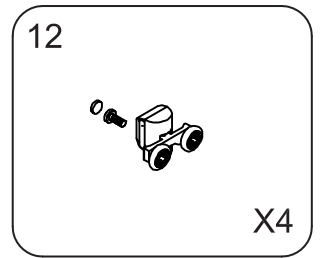
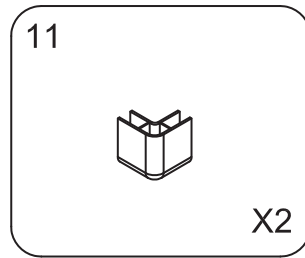
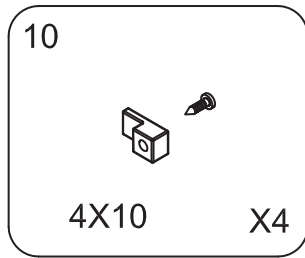
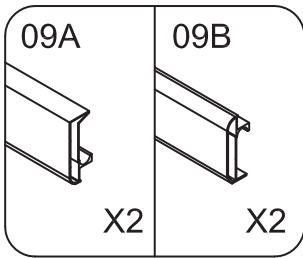
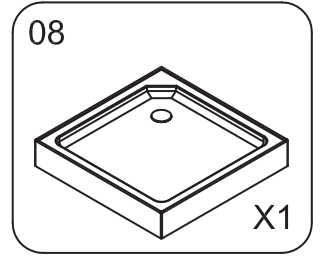
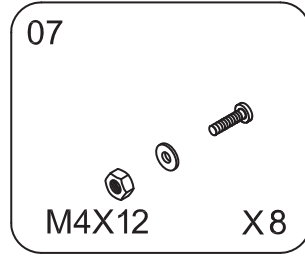
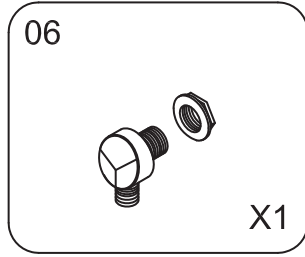
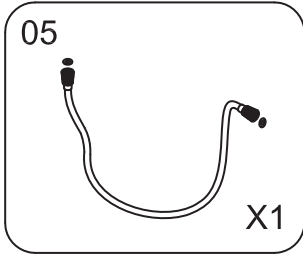
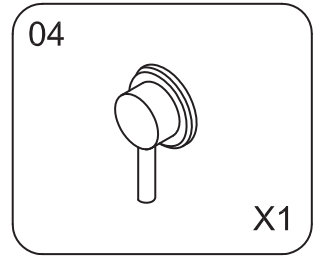
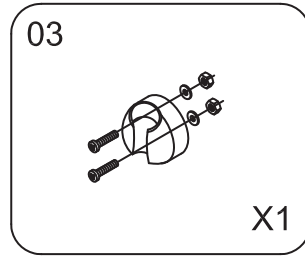
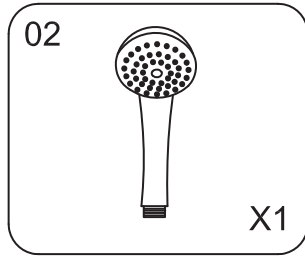
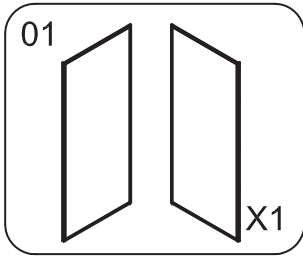

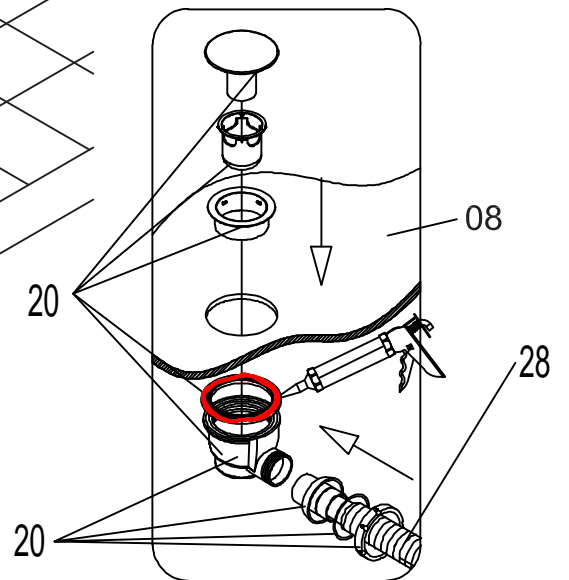
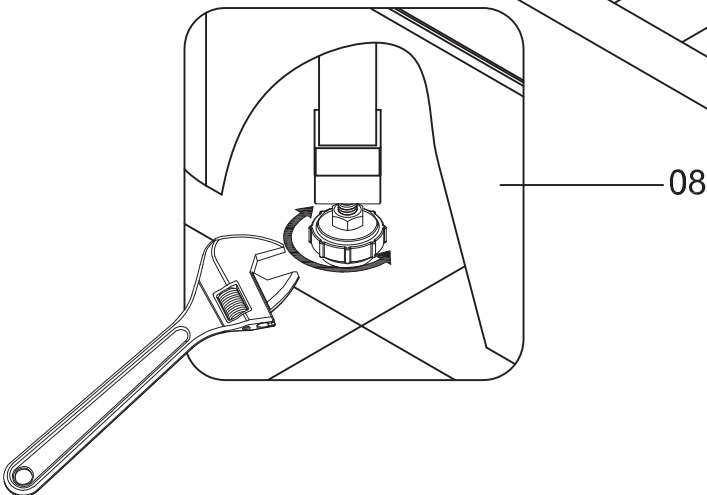
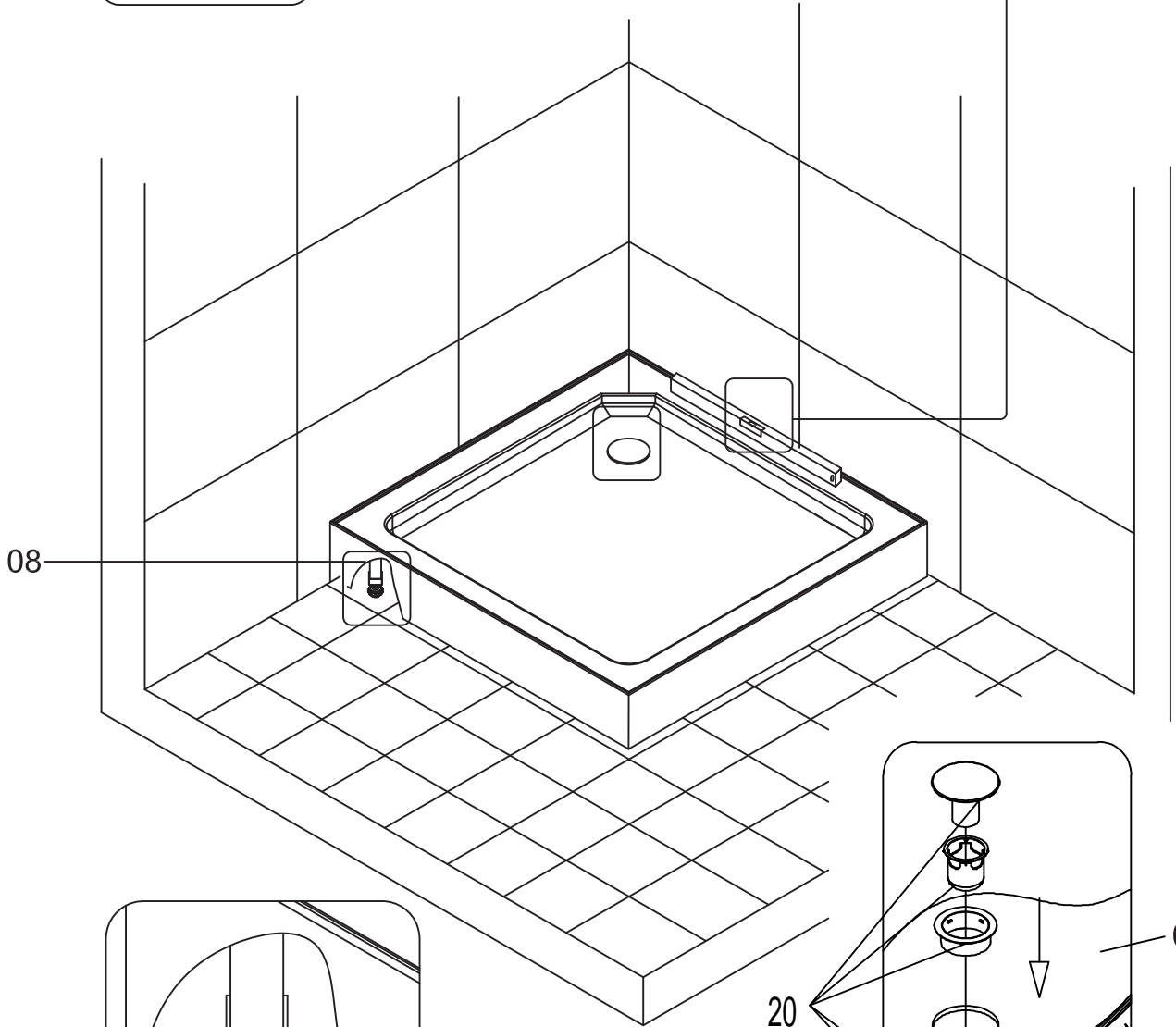
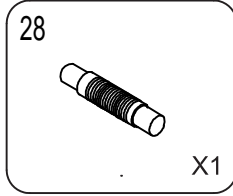
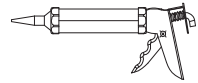
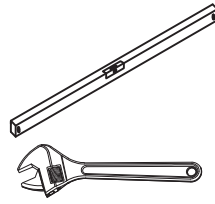
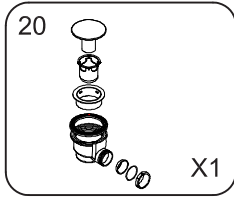
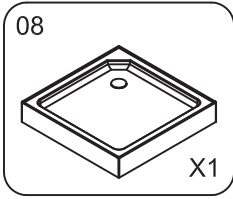

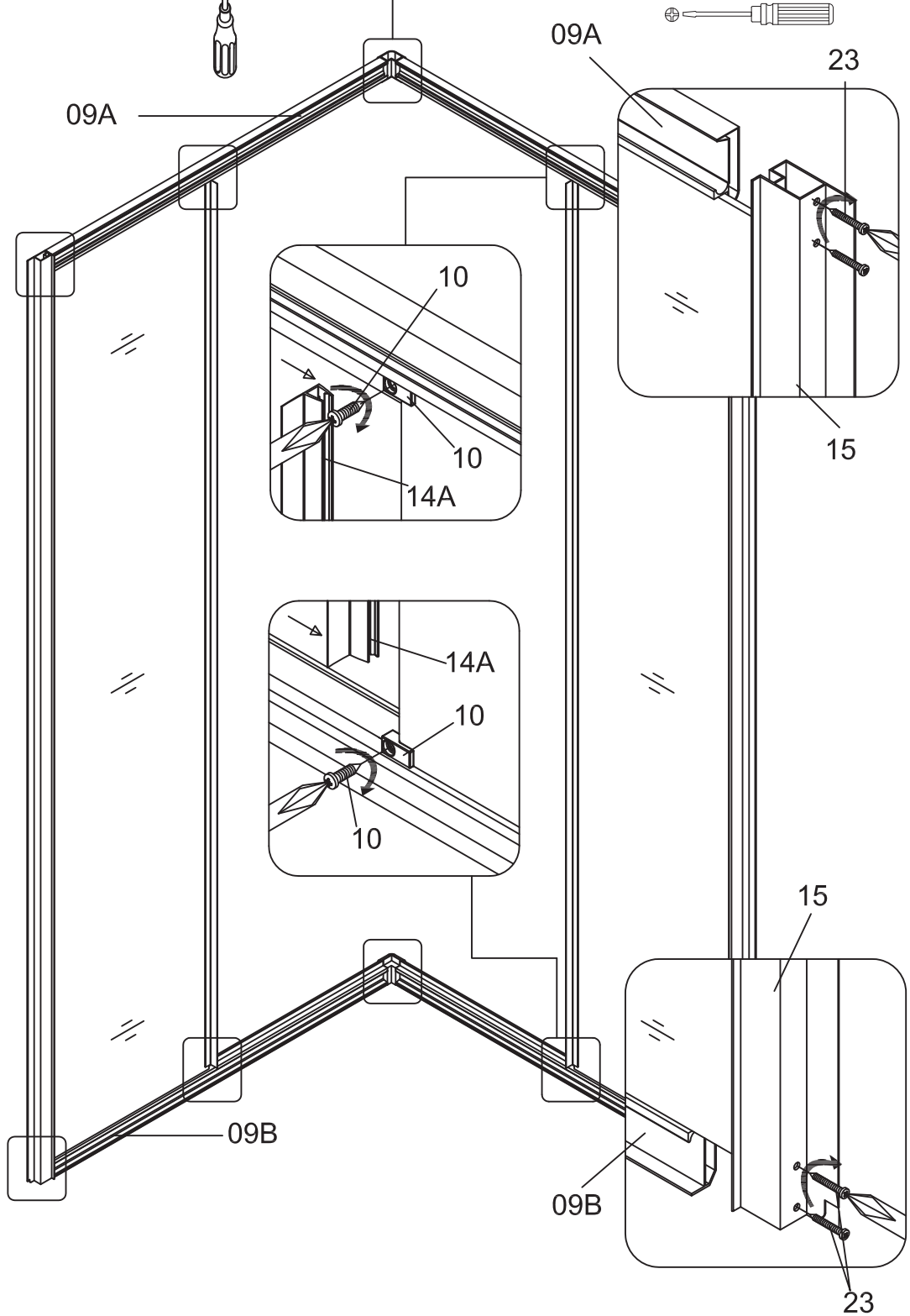
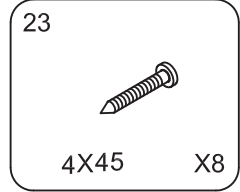
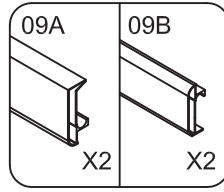
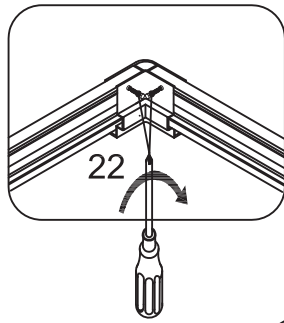
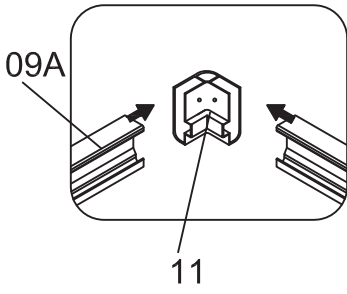
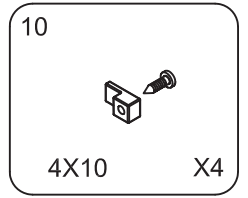
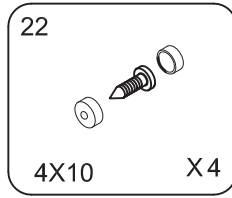
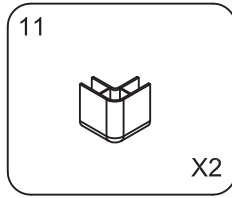
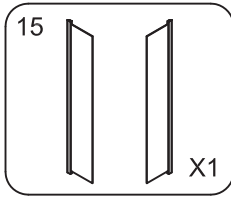
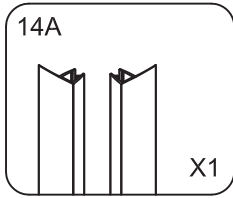

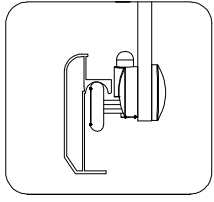
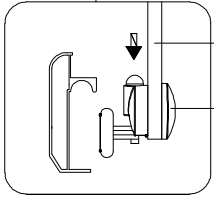
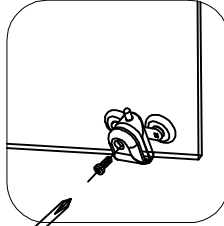
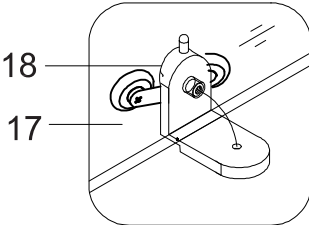
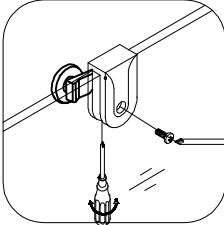
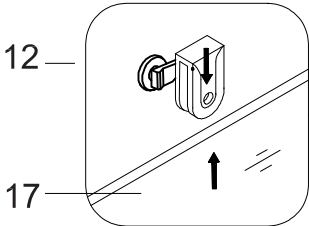
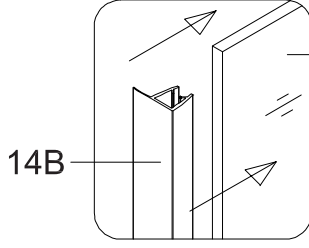
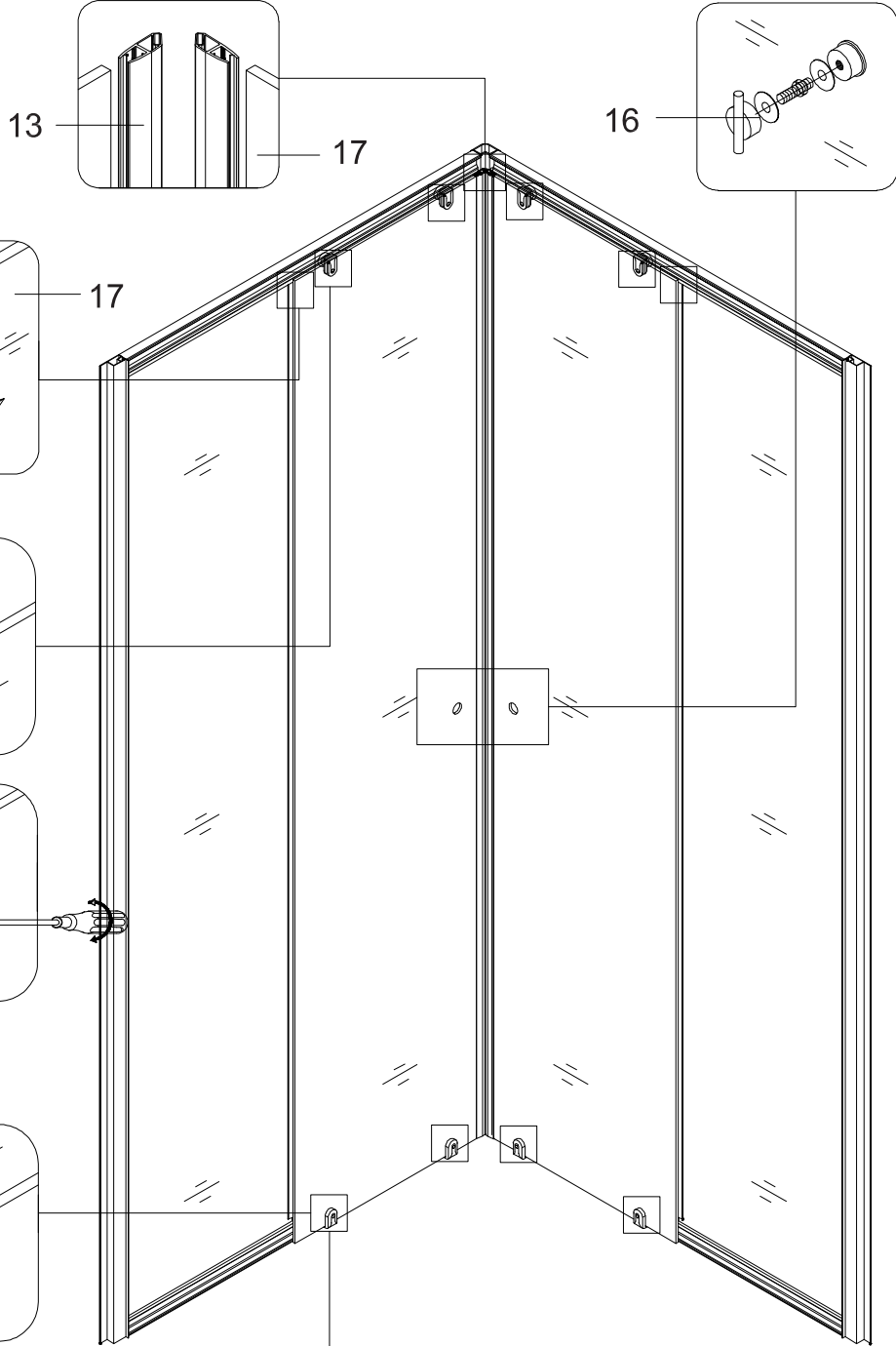
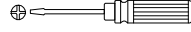
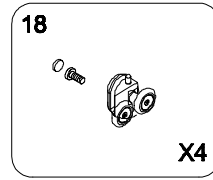
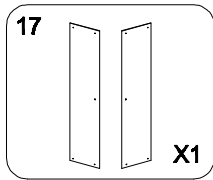
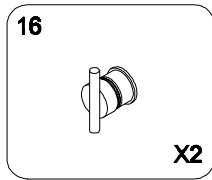
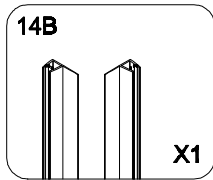
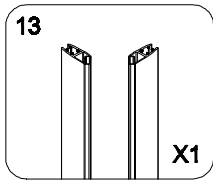
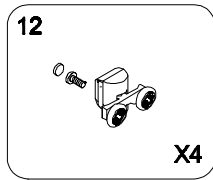

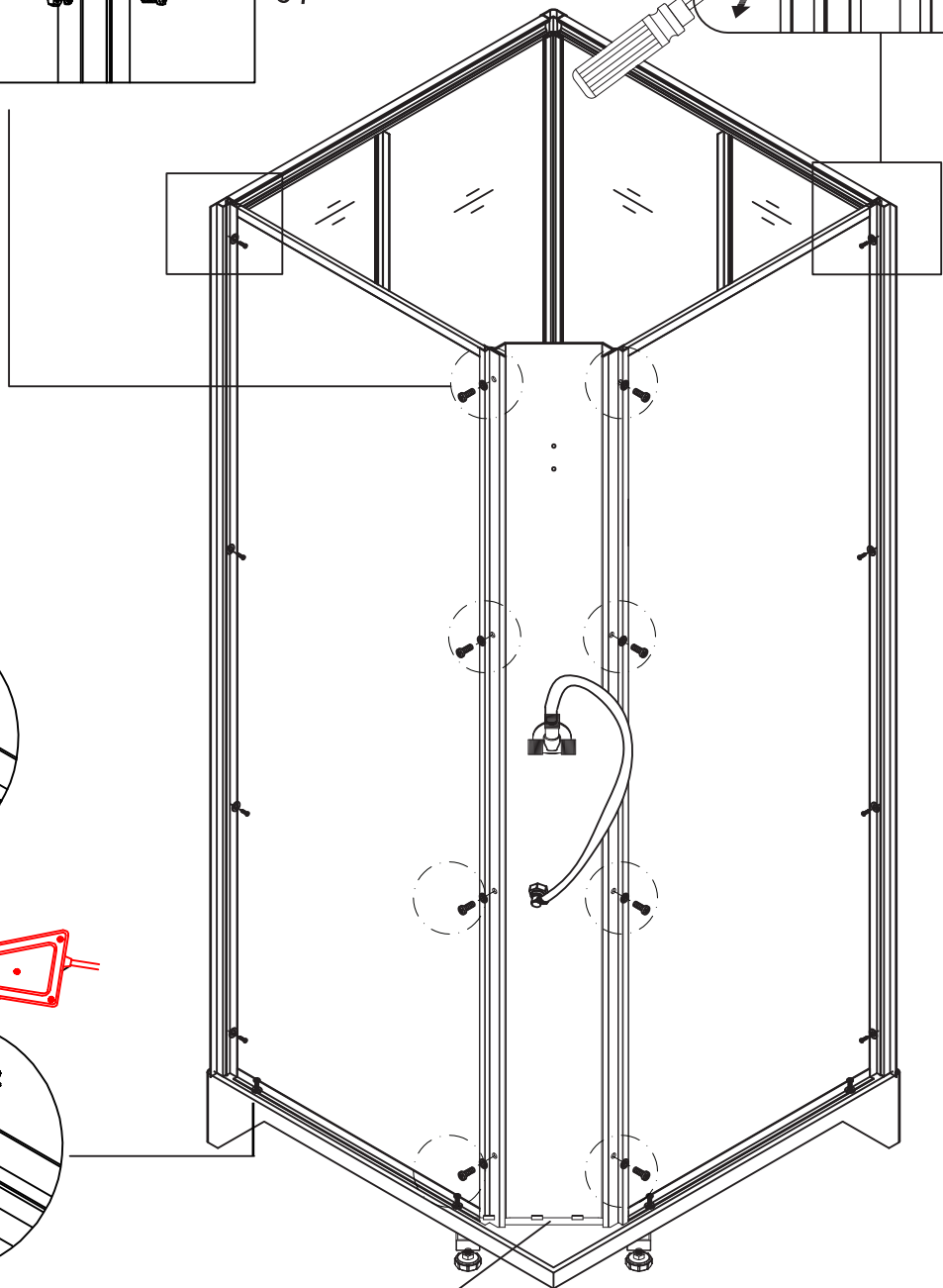
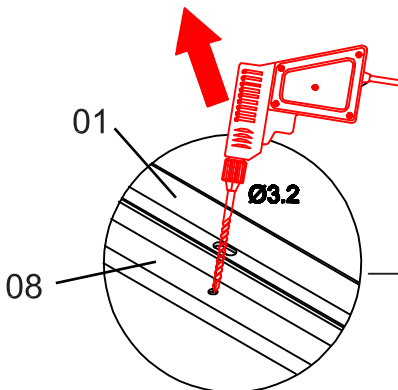
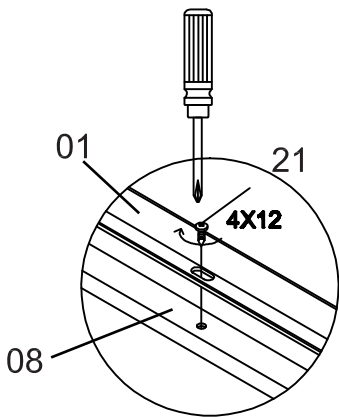
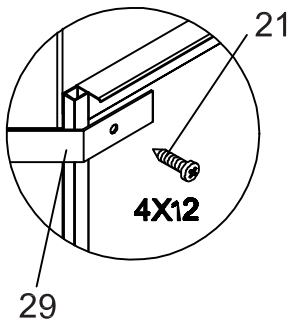
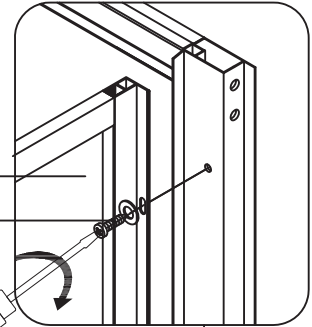
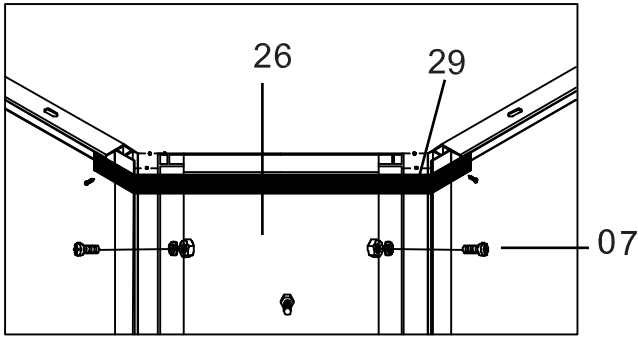
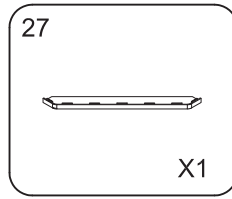
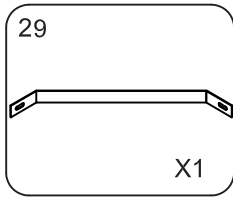
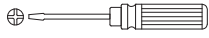
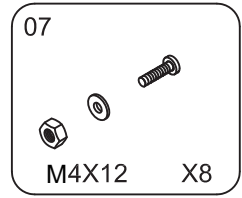
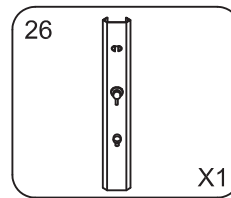
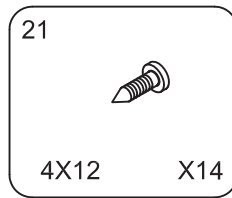
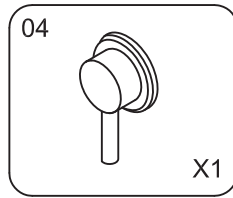
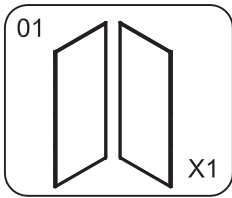

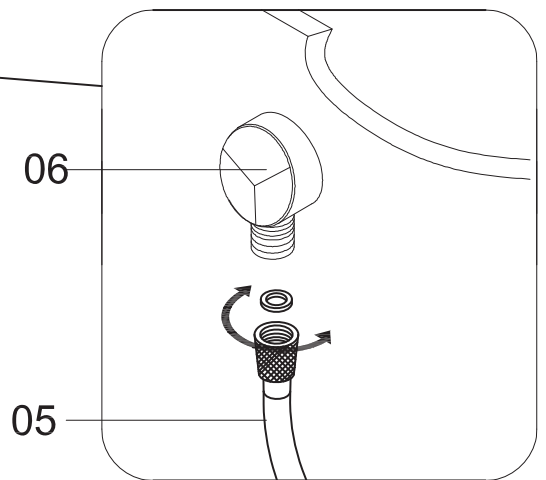
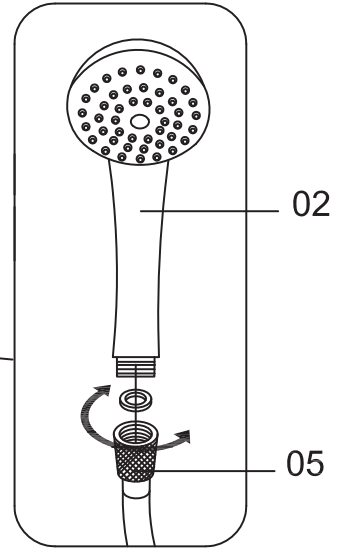
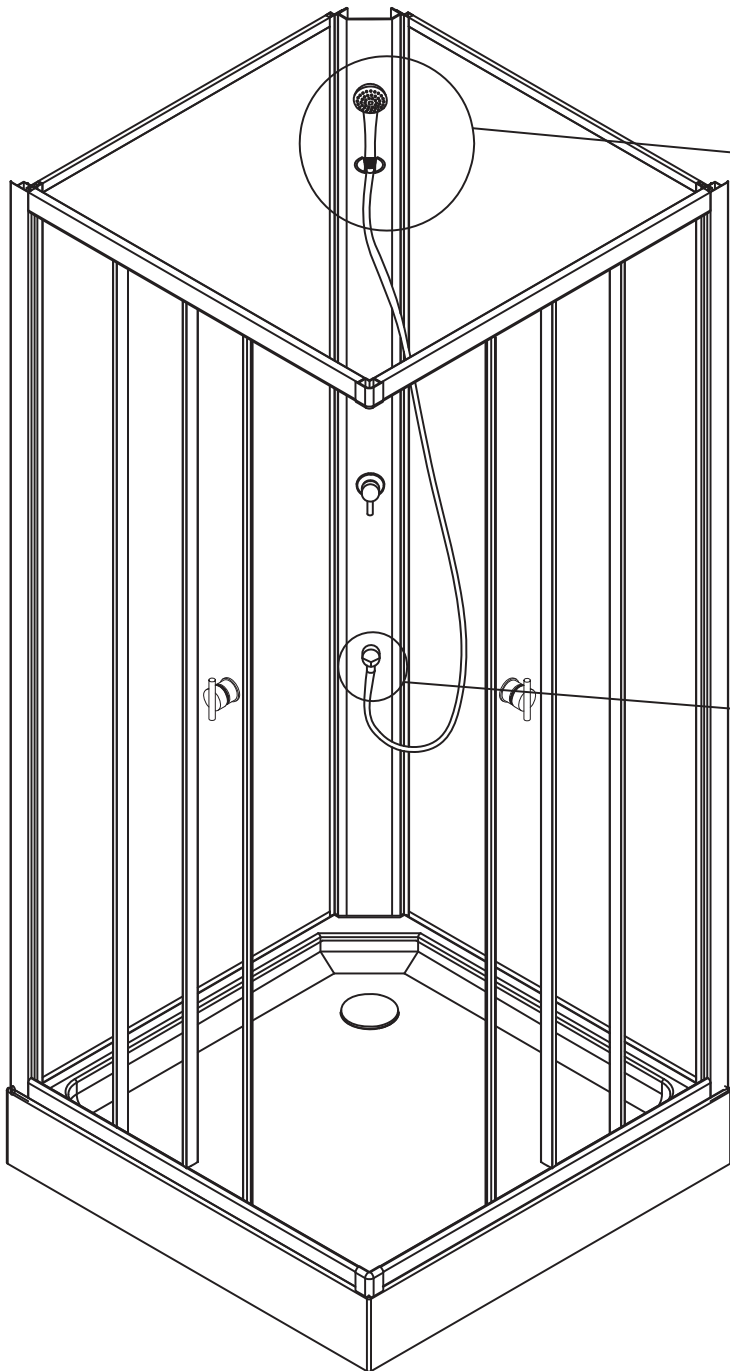
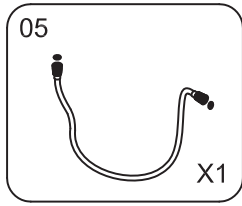
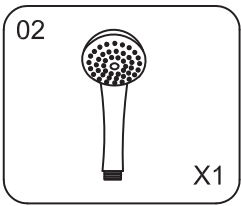



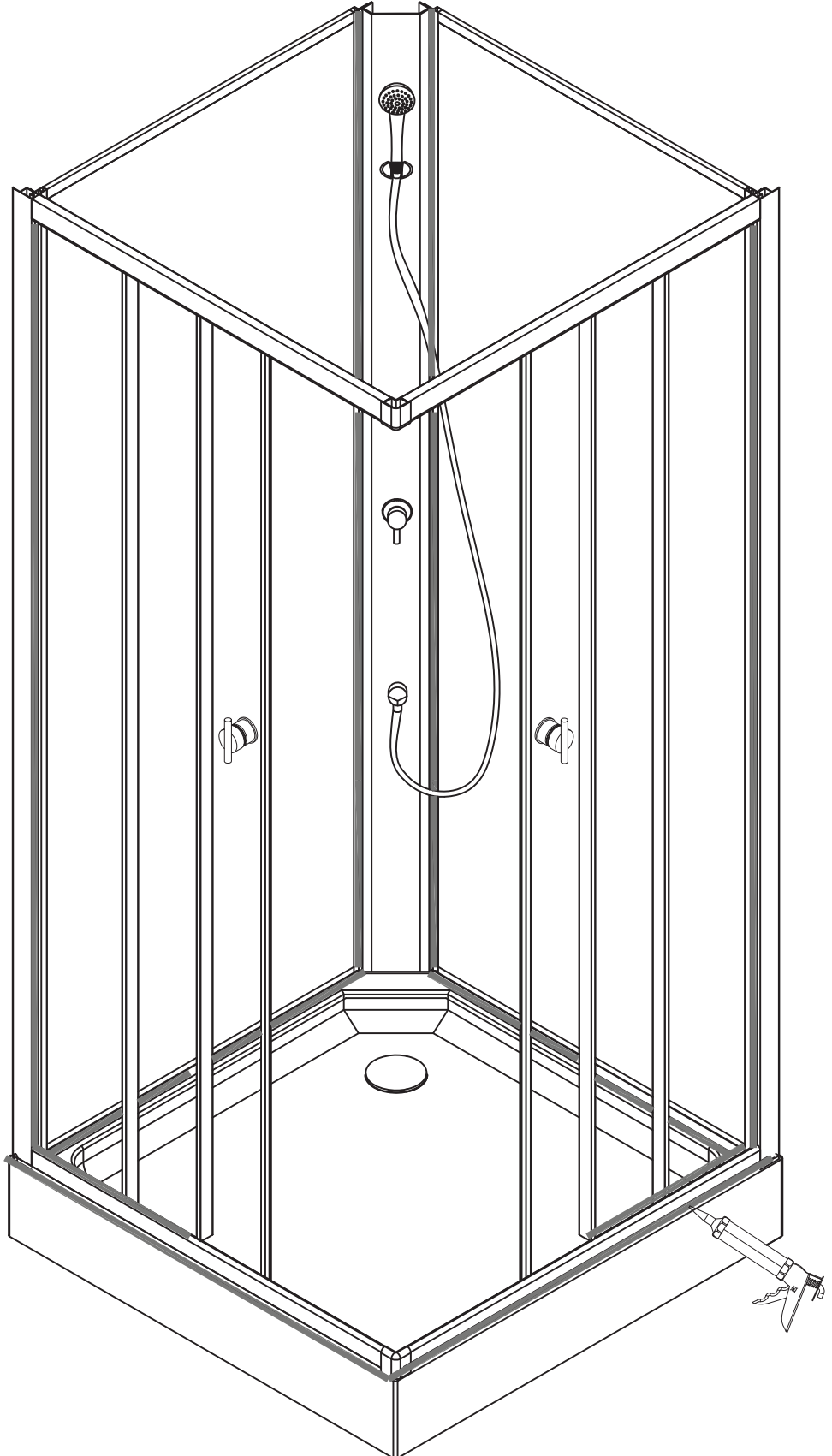
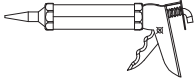



16

Dusar GmbH  
An der Strusbek 52a  
22926 Ahrensburg Germany  
www.dusar.com

Duschkabine 1152013A

Leistungserklärung: KF1610SC115201300

**EN 14428:2004 + A1:2008**

Duschkabine aus Aluminium und Glas

Verwendungszweck: Körperhygiene

Reinigbarkeit : Bestanden  
Brucheigenschaften : Bestanden  
Dauerhaftigkeit : Bestanden



16

Dusar GmbH  
An der Strusbek 52a  
22926 Ahrensburg Germany  
www.dusar.com

Duschkabine 1152013A

Leistungserklärung: KF1610SC115201300

**EN 14527:2006 + A1:2010 CL1+CL2**

Duschtasse aus ABS und Acryl  
Maße: 800 x 800 x 160mm

Verwendungszweck: Körperhygiene

Reinigbarkeit : Bestanden  
Dauerhaftigkeit : Bestanden



16

Dusar GmbH  
An der Strusbek 52a  
22926 Ahrensburg Germany  
www.dusar.com

shower cabin 1152013A

declaration of performance N° KF1610SC115201300

**EN 14428:2004 + A1:2008**

shower enclosure made of aluminum / glass

intended use : personal hygiene

Cleanability : Pass  
Impact resistance &  
Shatter property : Pass  
Durability : Pass



16

Dusar GmbH  
An der Strusbek 52a  
22926 Ahrensburg Germany  
www.dusar.com

shower cabin 1152013A

declaration of performance N° KF1610SC115201300

**EN 14527:2006 + A1:2010 CL1+CL2**

shower tray made of ABS / acrylic  
Dimensions : 800x800x160mm

intended use : personal hygiene

Cleanability : Pass  
Durability : Pass